

Towel Rail Installation

- . Review instructions carefully before installation
- . Installation should be completed by a suitably qualified person
- . Please dispose of packaging in a responsible manner

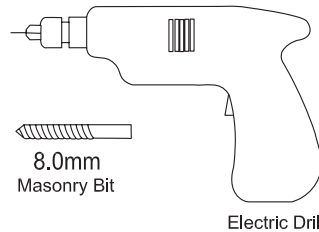

tools required

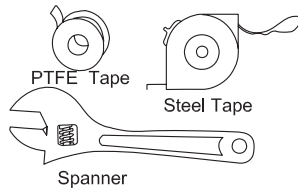
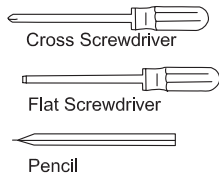

parts required

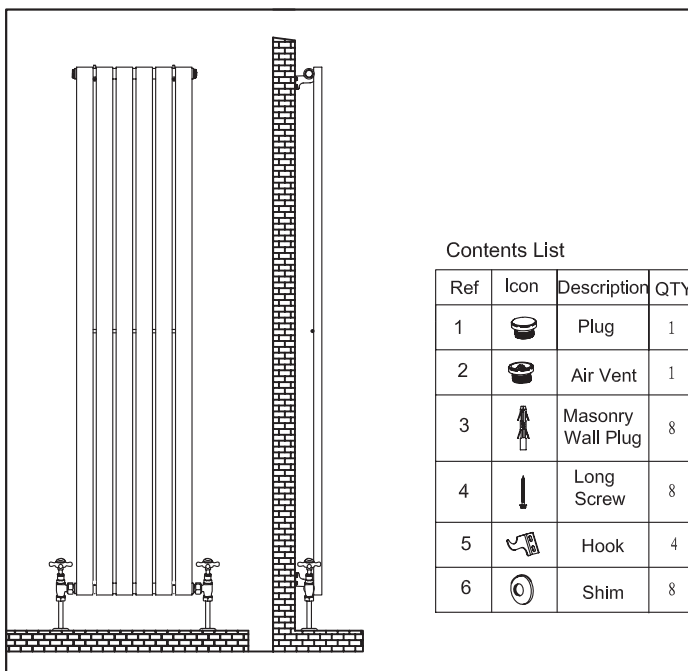
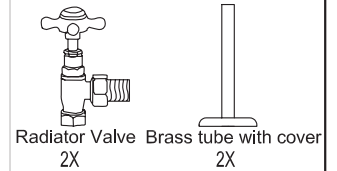

Contents List

Ref	Icon	Description	QTY
1		Plug	1
2		Air Vent	1
3		Masonry Wall Plug	8
4		Long Screw	8
5		Hook	4
6		Shim	8

A

1. Install 1 (plug) and 2 (air vent) in the right position. (figure I)
2. Please make sure PTFE tape was put in the threaded part while you install the radiator valves. (figure II)

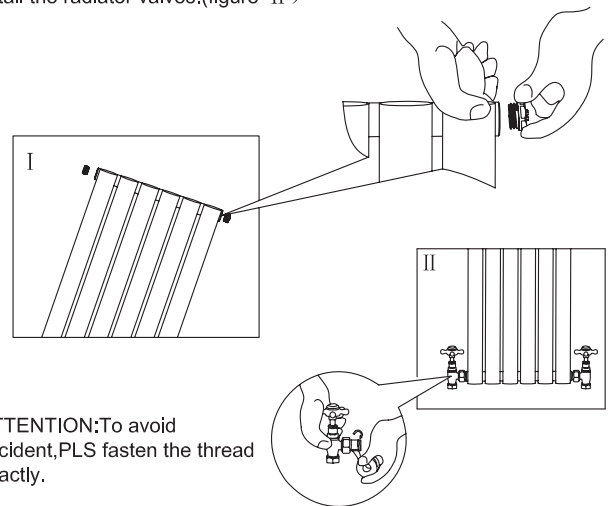

ATTENTION: To avoid accident, PLS fasten the thread exactly.

B

1. Choose an appropriate position and mark the fixing points with a pencil.

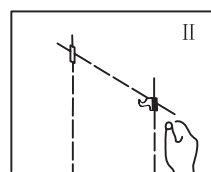
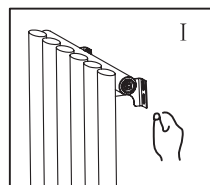
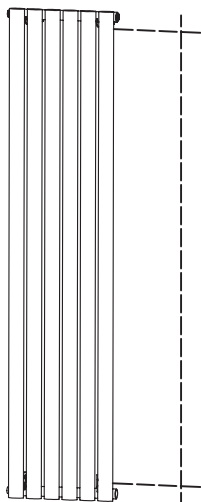

C

1. Drill a hole on the marked place by $\varnothing 8\text{mm}$ electric drill. (Figure I)
2. Insert 3 (Wall Plug) into the $\varnothing 8\text{mm}$ hole. (Figure II)
3. Place 4 (Long Screw) through 6 (Shim) and 5 (Hook), tighten it into the 3 (Wall plug). (Figure III)

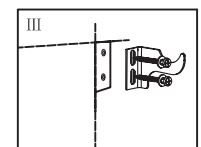
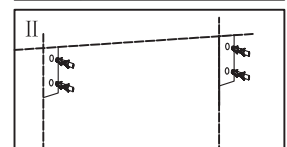
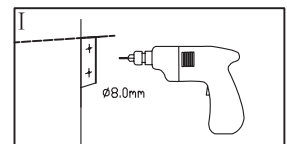

ATTENTION: Do not fix the bottom hooks completely because the position of towel warmer will be adjusted while installing.

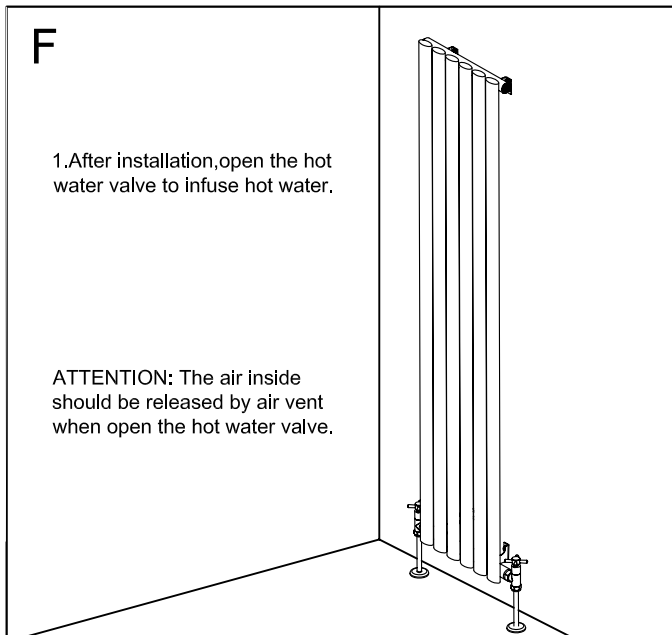
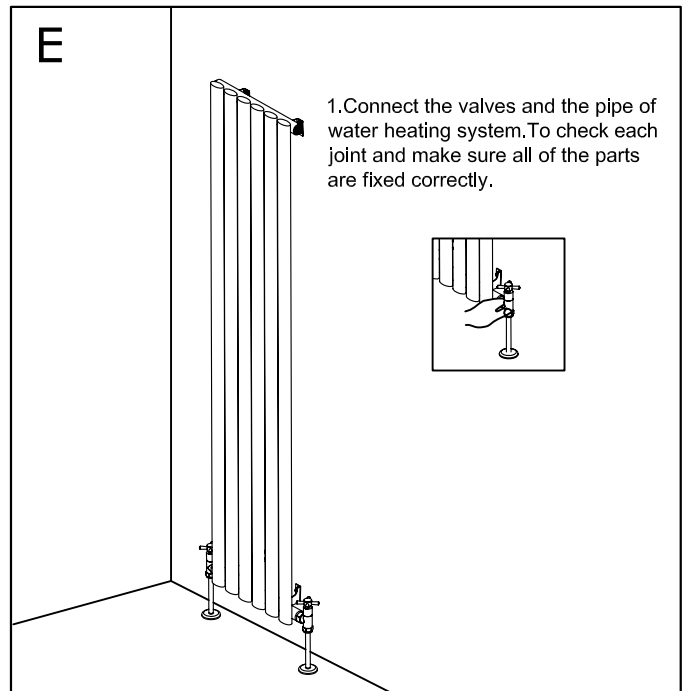
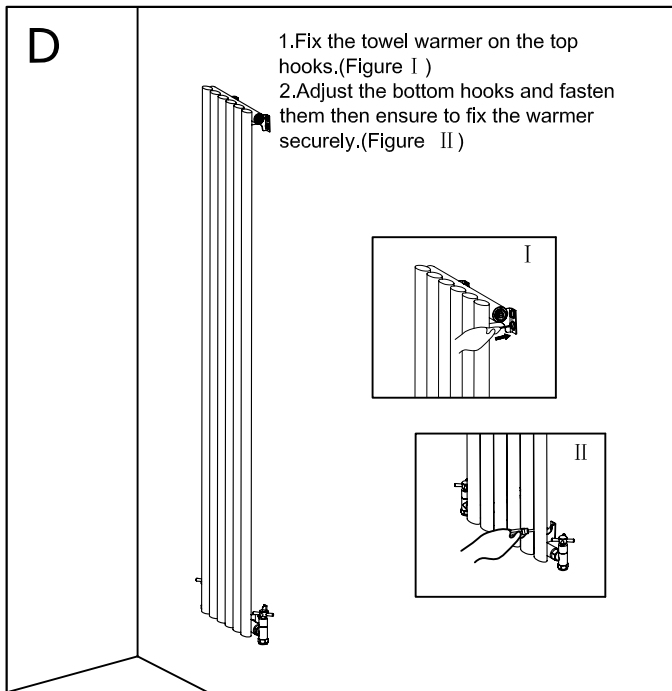

After installation . . .

- Use a screwdriver to open the air vent, open the inlet valve and let the water rush into the radiator. Check all connections for leaks.
- Once water overflows from the air vent, there is no air in the tube.
- Use a screwdriver to close the air vent, turn on the outlet valve and the radiator is ready for use.

After care . . .

- Classic radiators are made from steel with chrome plating, and should not be cleaned with corrosive or scouring cleaning agents.

Please note . . .

- This product can only be used at PN \leq 1MPa (10g/cm², 10 Bar), It should only be filled with water, and at a temperature below 100 °C (212 °F). See table below for installation requirements.
- If the temperature exceeds 48 °C (or 120 °F), please show a warning sign near the product to avoid burning and scolding accidents.

Fill ^{3/4} Full	Pressure	Temperature	Comments
water only	PN \leq 1Mpa	0° C < t \leq 100 °C	If ambient temperature drops below 1°C, drain out the water to prevent freezing. This product is used for drying towels with water heating